

Installation instructions:

1. Turn off the power switch.
2. Remove the front ring of the lamp .
3. Install the light source (GU10) .
4. ASSEMBLE the lamps and lanterns.
5. Connect to the power supply according to the drawing .
6. Switch on the power if above steps are done properly without any mistakes

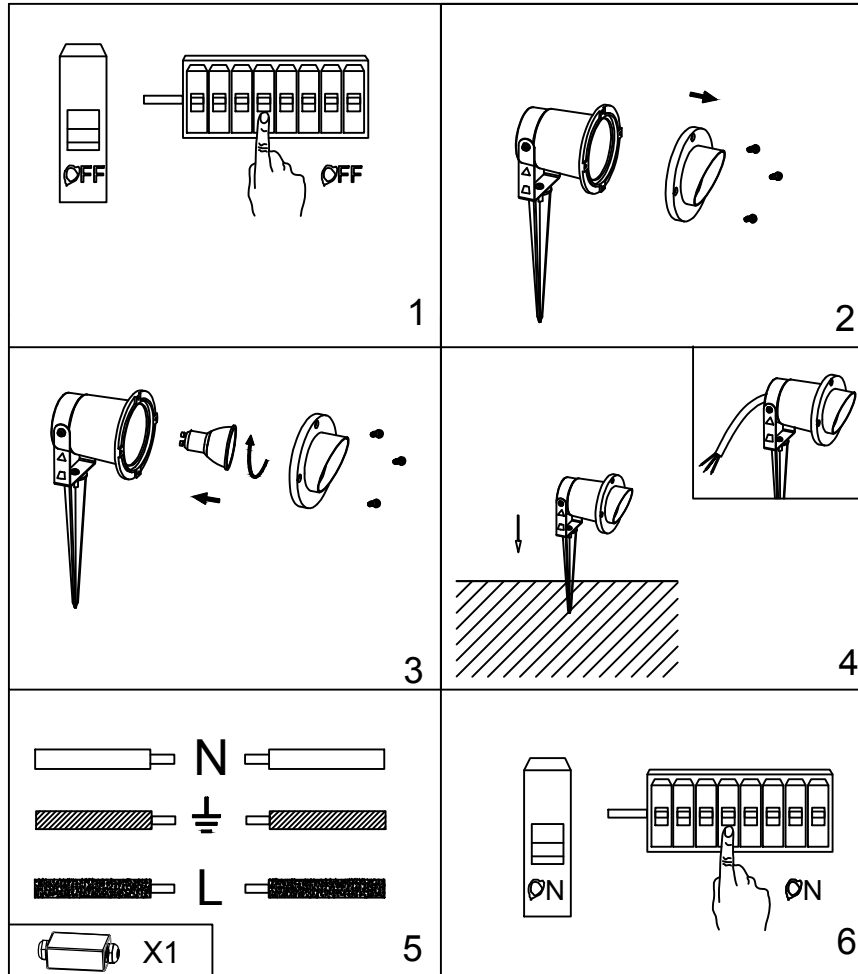

Installation instructions:

1. Turn off the power switch.
2. Remove the front ring of the lamp .
3. Install the light source (GU10) .
4. ASSEMBle the lamps and lanterns.
5. Connect to the power supply according to the drawing .
6. Switch on the power if above steps are done properly without any mistakes

